

New exclusive project in Alanya - Kargicak (009416)



252 000 € - 990 000 €

🏠 Floor area **65 m² - 322 m²**

🏠 Number of
rooms **1 bedroom**
 2 bedrooms
 3 bedrooms

3+1 penthouse

4+1 penthouse

 Furnitures **Partly**

 To the beach: **50 m**

 Location: **Turkey, Alanya, Kargicak**

 To the airport: **23 km**

 To the city centre: **12 km**

Options

- ✓ Sea view
- ✓ White goods
- ✓ Furniture
- ✓ Balcony/ Terrace
- ✓ Swimming pool
- ✓ Private territory
- ✓ Outdoor parking
- ✓ Mortgage
- ✓ Beachfront
- ✓ Elevator
- ✓ Playground
- ✓ Generator

Description

We are glad to present a new exclusive project in the Alanya region - Kargicak.

The new flagship on the Alanya coast is a premium-class residential complex on the first line from the Mediterranean Sea in a small ecologically clean area of Alanya - Kargicak.

Futuristic and unique design, a stunning atmosphere of the sea space from your windows - soothing, filled with the contemplation of all shades of blue and azure, colorful bursts of Mediterranean sunsets, a kaleidoscope of evening lights of the ancient Alanya fortress. Sea view from each apartment - we have collected in our project all the most daring ideas. We have chosen an excellent location; we have developed a unique design, and we have calculated every centimeter of the project in order to build a complex of a new level for you. For those who really appreciate quality, environmental friendliness, discreet luxury, and unity with nature. Our aspiration is a house where you will get the genuine pleasure of living a measured life with comfort and safety.

The complex with the infrastructure of a five-star hotel comprises two 6-story blocks with a total area of 2,387.46 m². Located 50 meters from the sandy beaches and the promenade.

Using our experience, we choose only new technologies and high-quality materials for construction. When designing, all the latest requirements for architectural standards and design innovations were considered. Allowing you to plunge into luxury in the bosom of nature of the year. Excellent investment prospects at the start of construction. Promising high rental income opportunities.

Location:

- Gazipasa Airport - 23 km
- to the center of Mahmutlar - 3 km
- to the center of Alanya - 15 km
- start of construction - March 2022
- completion of construction - December 2023.
- price increase at each stage of construction
- down payment - 35%, interest-free installments until December 2023.
- receiving Tapu - with 100% payment

Options for obtaining a vehicle:

- 1+1 - 4 pcs.
- 2+1 - 2 pcs.

- together - 3+1 and 1+1
- together - 3+1 penthouse and 1+1
- 4+1 or 4+1 penthouse

Types of apartments, number and area:

Block A:

- 1+1 apartments - 4 pcs. (65 m², 70m²)
- 1+1 garden apartments No. 1,2,3 - 67 m²
- 2+1 apartments - 9 pcs. (from 88 m² to 139 m²)
- 3+1 apartments - 2 pcs. (166m², 167m²)
- 4+1 apartments - 1 pc. (167 m²)
- 3+1 two-level - 2 pcs. (170m², 190m²)
- 4+1 two-level - 1 pc. (322 m²)
- in block A - jacuzzi on the balcony (sea side)

Block B:

- 2+1 apartments - 6 pcs. (92 m²)
- 3+1 two-level duplex with a garden - 2 pcs. (182 m²)
- 3+1 duplex penthouse - 2 pcs. (197 m²)
- total number of apartments - 32 pcs
- ceiling height - 3.00 m
- between blocks - 13-15 meters

Characteristics of the apartments:

- steel front door
- double glazed aluminum windows
- balcony
- interior doors
- built-in wardrobe
- built-in kitchen set with granite/quartz worktop
- equipped bathroom (shower, plumbing kit, faucets, built-in furniture, wall mirror, water heater)

- a basic and decorative lighting system
- flooring - high-quality ceramic tiles
- washable paint on walls
- sockets and switches
- tv cable
- inverter air conditioner

Infrastructure of the complex:

- heated outdoor infinity pool
- Children's swimming pool
- sauna
- Turkish bath (Hamam)
- massage room
- rest zone
- vitamin bar
- changing rooms, showers, toilets
- lobby
- 2 elevators in each block
- gym
- playground for children
- landscaped garden
- security 24 hours
- video surveillance system
- satellite system and internet
- outdoor parking
- covered parking for 14 cars
- uninterruptible power supply generator
- Management Company

Price updated 05/30/2022

Updated 05.11.2024

Photo gallery



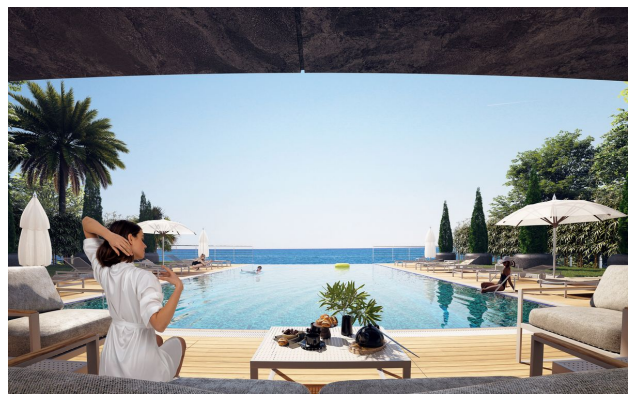
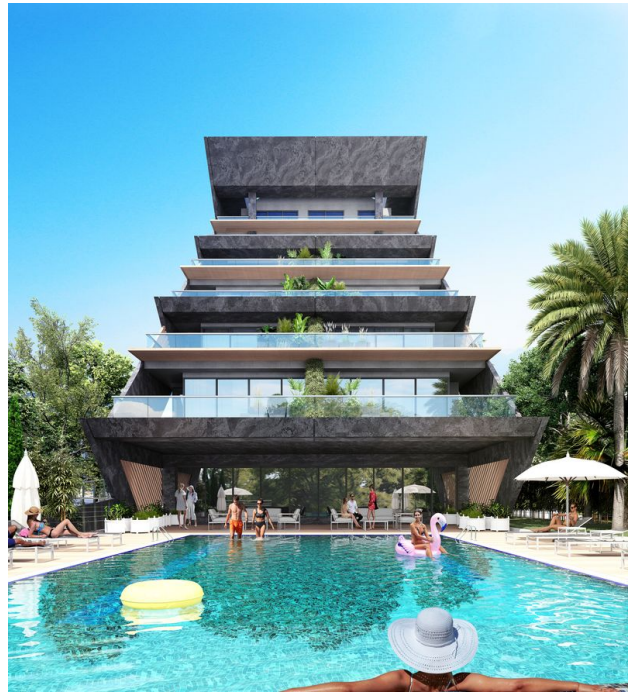





B BLOK-NORMAL KAT PLANI



B BLOK-ÇATI ARASI PLANI



B BLOK-BODURUM KAT PLANI



B BLOK-4. KAT PLANI



A-BLOK / 4+1	
22	
1	10,00 m ²
2	10,00 m ²
3	10,00 m ²
4	10,00 m ²
5	10,00 m ²
6	10,00 m ²
7	10,00 m ²
8	10,00 m ²
9	10,00 m ²
10	10,00 m ²
11	10,00 m ²
12	10,00 m ²
13	10,00 m ²
14	10,00 m ²
15	10,00 m ²
16	10,00 m ²
17	10,00 m ²
18	10,00 m ²
19	10,00 m ²
20	10,00 m ²
21	10,00 m ²
22	10,00 m ²
Toplam Alan	220,00 m²



A-BLOK / 3+1	
21	
1	4,80 m ²
2	14,50 m ²
3	4,50 m ²
4	10,50 m ²
5	11,00 m ²
6	5,20 m ²
7	4,50 m ²
8	8,00 m ²
9	14,50 m ²
10	3,00 m ²
11	22,00 m ²
12	11,00 m ²
13	12,00 m ²
14	12,00 m ²
Toplam Alan	130,00 m²



A-BLOK / 3+1	
20	
1	2,30 m ²
2	14,20 m ²
3	2,40 m ²
4	11,70 m ²
5	4,60 m ²
6	21,50 m ²
7	4,70 m ²
8	7,50 m ²
9	50,50 m ²
10	11,00 m ²
11	44,20 m ²
12	10,00 m ²
13	11,00 m ²
Toplam Alan	140,00 m²



A-BLOK / 2+1	
19	
1	5,60 m ²
2	33,00 m ²
3	10,00 m ²
4	14,20 m ²
5	4,30 m ²
6	31,60 m ²
7	7,30 m ²
8	12,00 m ²
Toplam Alan	118,00 m²



A-BLOK / 2+1	
18	
1	6,95 m ²
2	32,40 m ²
3	11,25 m ²
4	15,60 m ²
5	4,70 m ²
6	4,70 m ²
7	31,40 m ²
8	10,00 m ²
9	12,00 m ²
Toplam Alan	129,00 m²

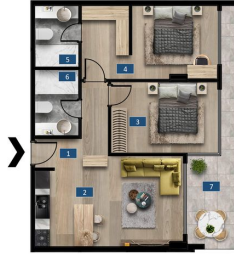

A-BLOK / 2+1		
17		
1	Antrre	6,10 m ²
2	Salon&Mutfak	20,20 m ²
3	Yatak Odası	13,60 m ²
4	Yatak Odası	10,30 m ²
5	Çiğdemli Odası	5,90 m ²
6	Banyo	4,50 m ²
7	Balkon	4,90 m ²
8	Duvar	4,90 m ²
9	Duvar	7,40 m ²
10	Ortak Alan	12,00 m ²
Toplam Alan		93,00 m ²



A-BLOK / 2+1		
11,16		
1	Antrre	4,50 m ²
2	Salon&Mutfak	12,40 m ²
3	Yatak Odası	13,40 m ²
4	Banyo	5,10 m ²
5	Yatak Odası	11,70 m ²
6	Banyo	4,00 m ²
7	Balkon	7,50 m ²
8	Duvar	6,50 m ²
9	Ortak Alan	12,00 m ²
Toplam Alan		88,00 m ²



A-BLOK / 2+1		
15		
1	Antrre	7,60 m ²
2	Salon&Mutfak	20,40 m ²
3	Yatak Odası	13,10 m ²
4	Banyo	6,40 m ²
5	Yatak Odası	20,30 m ²
6	Banyo	5,40 m ²
7	Balkon	32,40 m ²
8	Duvar	9,20 m ²
9	Ortak Alan	12,00 m ²
Toplam Alan		139,00 m ²



A-BLOK / 2+1		
14		
1	Antrre	7,40 m ²
2	Salon&Mutfak	12,40 m ²
3	Yatak Odası	12,50 m ²
4	Yatak Odası	15,40 m ²
5	Banyo	4,80 m ²
6	Banyo	5,10 m ²
7	Balkon	11,40 m ²
8	Duvar	8,00 m ²
9	Ortak Alan	12,00 m ²
Toplam Alan		129,00 m ²



A-BLOK / 2+1		
11,16		
1	Antrre	4,50 m ²
2	Salon&Mutfak	23,30 m ²
3	Yatak Odası	13,40 m ²
4	Yatak Odası	14,50 m ²
5	Banyo	5,10 m ²
6	Yatak Odası	13,70 m ²
7	Banyo	4,00 m ²
8	Balkon	7,50 m ²
9	Duvar	4,50 m ²
10	Ortak Alan	12,00 m ²
Toplam Alan		88,00 m ²



A-BLOK / 3+1		
10		
1	Antrre&Hnl	12,00 m ²
2	Salon&Mutfak	32,40 m ²
3	Yatak Odası	13,40 m ²
4	Yatak Odası	14,50 m ²
5	Banyo	11,40 m ²
6	Yatak Odası	20,30 m ²
7	Banyo	5,40 m ²
8	Balkon	33,20 m ²
9	Duvar	11,20 m ²
10	Ortak Alan	12,00 m ²
Toplam Alan		167,00 m ²



A-BLOK / 2+1		
9		
1	Antrre&Hnl	7,40 m ²
2	Salon&Mutfak	32,40 m ²
3	Yatak Odası	13,40 m ²
4	Yatak Odası	15,50 m ²
5	Banyo	4,90 m ²
6	Banyo	5,10 m ²
7	Balkon	31,50 m ²
8	Duvar	9,40 m ²
9	Ortak Alan	13,30 m ²
Toplam Alan		132,00 m ²



A-BLOK / 2+1		
8		
1	Antrre&Hnl	5,80 m ²
2	Salon&Mutfak	21,40 m ²
3	Yatak Odası	13,40 m ²
4	Yatak Odası	18,50 m ²
5	Banyo	4,50 m ²
6	Banyo	4,70 m ²
7	Balkon	9,30 m ²
8	Duvar	7,50 m ²
9	Ortak Alan	13,30 m ²
Toplam Alan		98,00 m ²