







Apartments in a new residential complex under construction in Mahmutlar, Alanya (001131)



250 000 €

 Floor area	62 m² - 187 m²
 Number of rooms	1 bedroom
	2+1 penthouse
	4+1 penthouse
 Furnitures	Partly
 To the beach:	120 m
 Location:	Turkey, Alanya, Mahmutlar
 To the airport:	32 km
 To the city centre:	15 km

Options

- ✓ Panoramic view
- ✓ Balcony/ Terrace
- ✓ Swimming pool
- ✓ Private territory
- ✓ Outdoor parking
- ✓ 0% installment
- ✓ Security
- ✓ Garden
- ✓ Elevator
- ✓ Playground
- ✓ Generator

Description

Alanya impresses many with its world-famous Cleopatra Beach and the longest blue flag beaches in the Mediterranean. Our project, is 120 meters from the sea, in an area with a very developed infrastructure. The complex is located just 15 km from the center of Alanya and 32 km from Gazipasa Airport.

Our project is focused on the needs, desires, and conveniences of customers; outdoor and indoor swimming pool, Turkish bath, sauna, playground, fitness, parking, and reception, to name a few. The project meets all your expectations, combining traditional architecture in keeping with the times, and is also in the Mahmutlar area of Alanya.

Our project is intertwined with social infrastructure and urban life, and yet it covers an area of 3350 square meters. In the complex, which comprises 2 blocks and 12 floors, there are different apartment layouts, such as 1 + 1, 2 + 1, and 4 + 1. Near the complex, there are cafes, restaurants, bars, and shopping centers.

All apartments will be equipped with steel doors, internal automation systems, special-sized waterproof ceramics on surfaces, walls with antibacterial coating for your health, and materials to isolate room noise. Our project includes a 24-hour security system, generators, and fire detectors. According to the developer, the apartment is covered by a 5-year warranty, as well as a 2-year warranty for outdoor work, including electricity and water supply.

You can find everything you want in our complex. You can work out in the fitness center of our complex and then relax in the sauna. If you wish, you can spend time in the hammam, and then go to the indoor pool. You can spend time with your family on the playground or enjoy afternoon tea with friends in the lobby to relieve your tiredness. Take advantage of all the possibilities of the infrastructure of the complex!

From the moment you cross the threshold of the house, you will feel the pleasure of an unusual design. The signature of our creative architects is in every corner of your new home, from the living room chandelier to the doorknobs. From different surfaces to original details, from functional entry niches to special maple cabinetry systems, every element here has been thought of to create a comfortable and beautiful home.

Information updated 16.11.2023

Photo gallery





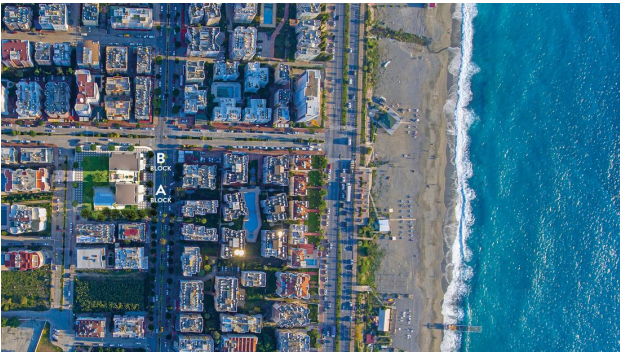



MEHMET ÇAKIR CD.

BARBAROS CAĐDESİ

A NORMAL FLOOR PLANS
НОРМАЛЬНЫЕ ПЛАНЫ ЭТАЖЕЙ



A DUPLEX UPSTAIRS FLOOR PLAN
ПЛАН ДУПЛЕКСА НА ВТОРОМ ЭТАЖЕ



A DUPLEX DOWNSTAIRS FLOOR PLAN
ПЛАН ДУПЛЕКСА НА ПЕРВОМ ЭТАЖЕ

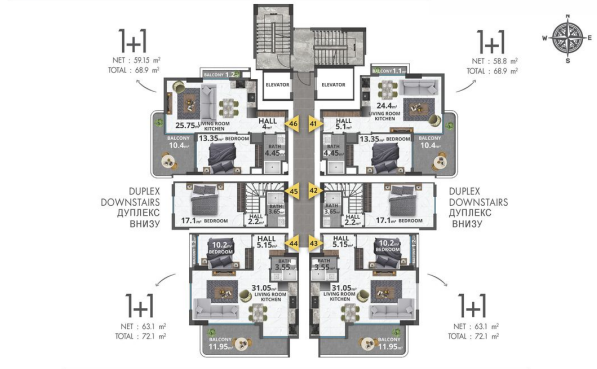

A 4+1 DUPLEX
ПЛАН ДУПЛЕКСА NET : 186.20 m²
TOTAL : 217.40 m²



A 1+1 NET : 63.10 m²
TOTAL : 72.10 m²



A 1+1 NET : 63.10 m²
TOTAL : 72.10 m²



A 4+1 DUPLEX
ПЛАН ДУПЛЕКСА NET : 186.20 m²
TOTAL : 217.40 m²



A 2+1 NET : 89.55 m²
TOTAL : 102.70 m²

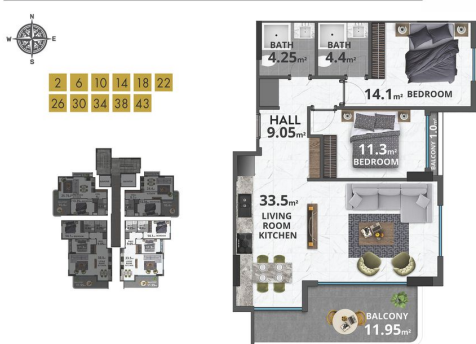

A 2+1 NET : 89.55 m²
TOTAL : 102.70 m²



A 1+1 NET : 58.15 m²
TOTAL : 69.90 m²

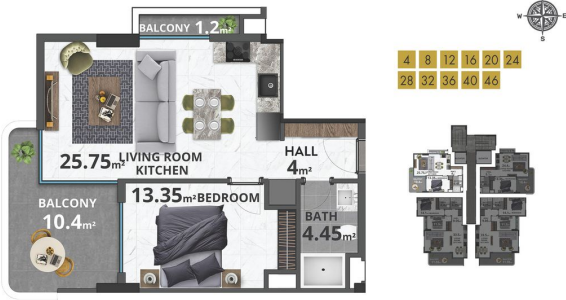

A 1+1 NET : 58.80 m²
TOTAL : 68.90 m²

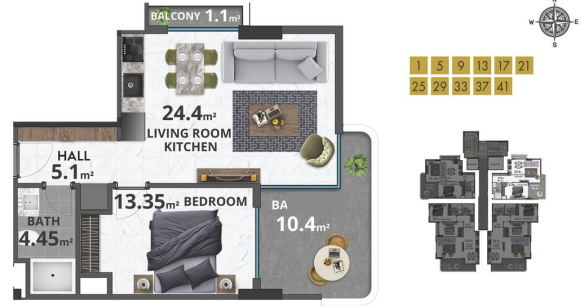

A NORMAL FLOOR PLANS
НОРМАЛЬНЫЕ ПЛАНЫ ЭТАЖЕЙ

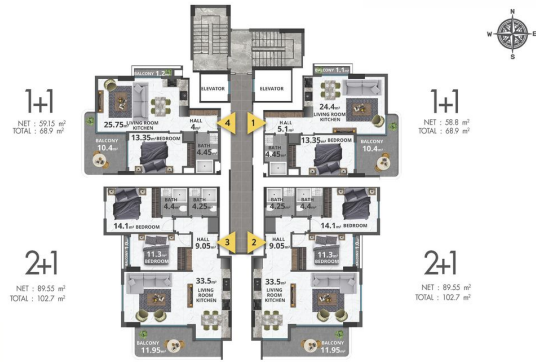

A DUPLEX UPSTAIRS FLOOR PLAN
ПЛАН ДУПЛЕКСА НА ВТОРОМ ЭТАЖЕ



A DUPLEX DOWNSTAIRS FLOOR PLAN
ПЛАН ДУПЛЕКСА НА ПЕРВОМ ЭТАЖЕ

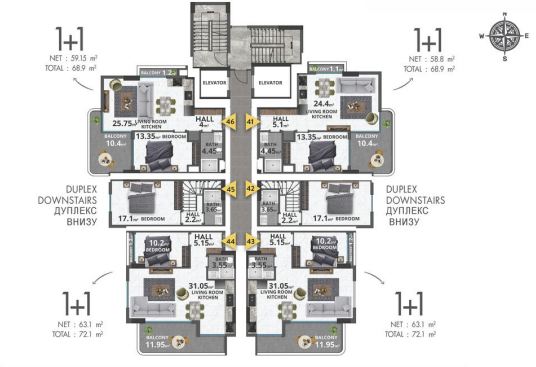

B NORMAL FLOOR PLANS
НОРМАЛЬНЫЕ ПЛАНЫ ЭТАЖЕЙ

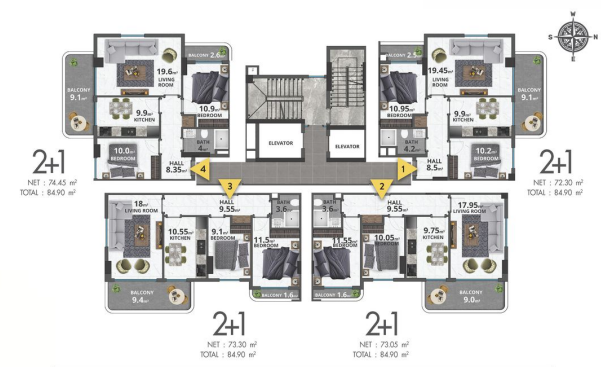

B 12TH FLOOR PLANS
ПЛАНЫ 12 ЭТАЖА



B 11TH FLOOR PLANS
ПЛАНЫ 11 ЭТАЖА



B 10TH FLOOR PLANS
ПЛАНЫ 10 ЭТАЖА



B 4+1 DUPLEX NET : 188.10 m²
ПЛАН ДУПЛЕКСА TOTAL : 216.20 m²



B 1+1 NET : 49.40 m²
TOTAL : 54.35 m²

