

Modern apartments in a new residential complex in the Chiplakly area (026157)



200 000 €

🏠 Floor area **58 m² - 195 m²**

🏠 Number of rooms **1 bedroom**
2 bedrooms
3+1 penthouse
4+1 penthouse

🪑 Furnitures **Partly**

 To the beach: **3200 m**

 Location: **Turkey, Alanya, Chiplakly**

 To the airport: **35 km**

 To the city centre: **4 km**

Options

- ✓ Balcony/ Terrace
- ✓ Swimming pool
- ✓ Private territory
- ✓ Elevator
- ✓ Playground
- ✓ Generator

Description

The project will be built in the Chiplakli area on a total area of 5172 m² and in a healthy zone, surrounded by panoramic views of nature and a lot of clean air.

There are 60 apartments in the complex:

- 1+1: 32 pieces
- 2+1: 16 pcs.
- 3+1 DUPLEX: 8 pcs.
- 4+1 DUPLEX: 4 pcs.

In order to have a good time, in the complex:

- open pool,
- sauna,
- generator,

- Gym,
- playground,
- camellia,
- brazier,
- parking.

The Chiplakli area is located two kilometers from Alanya. The area is well-maintained, with all the urban infrastructure, most of all it is famous for its nature and clean air.

This ecologically clean area with the world famous Cleopatra Beach. In shops and markets you can find the freshest fruits, vegetables and organic products. There are 5 hospitals and clinics, 15 pharmacies, 8 veterinary clinics and dental clinics in the center of Alanya. There are also branches of international logistics companies within walking distance from our project.

It is a very popular area for investment as well as for a quiet daily life in nature.

Location:

- 3.75 km from the center of Alanya,
- 3.2 km from the sea.

In addition, the complex is within walking distance of chain stores such as Migros, Carrefour, A101 and Bim.

Initial payment 40%, **INSTALLATION FOR THE RESIDUAL AMOUNT BEFORE CONSTRUCTION COMPLETION.**

Construction start date: 15.03.2023

Construction completion date: 15.09.2024

Information updated: 12.12.2023

Photo gallery

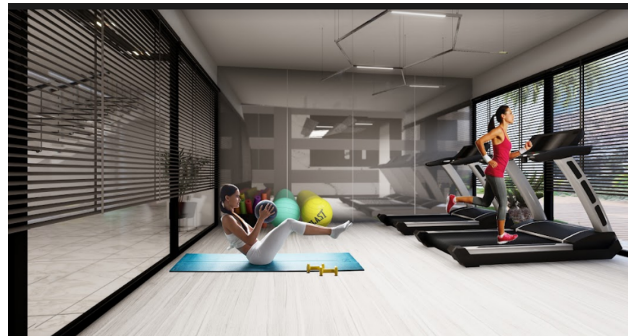



Scan the QR code to open the original page