

Apartment from a developer in the heart of East London, on the waterfront of the River Lea (006283)



555 100 €

 Floor area **52 m²**

 Number of rooms **1 bedroom**

 Furnitures **Partly**

 To the beach: **m**

 Location: **United Kingdom, London**

 To the airport: **km**



To the city
centre:

km

Options

- ✓ Balcony/ Terrace
- ✓ Swimming pool
- ✓ Private territory
- ✓ Elevator
- ✓ Playground

Description

The hotel is located in the heart of East London, on the banks of the River Lea.

The poplar district with well-maintained residential buildings and public spaces adjoins the street. Canary Wharf business district. Nearby is the sports complex "Poplar Baths".

Canary Wharf can be reached by water bus in 15 minutes from Thames Clipper station nearby. East India Light Rail Station and Canning Town MTR Station are within a 15-minute walk.

London City Airport can be reached in 10 minutes by car, Heathrow and Luton airports are 1 hour away.

Multifunctional complex for 2,800 apartments on the banks of the Lea River in the central part of the city.

The complex consists of elegant 12- and 14-story buildings spanning over 2 acres.

500-meter walking routes will be laid along the embankment, cozy cafes, restaurants and shops will open.

Description:

- 1 bedroom
- area 51.9 m2
- 6th floor

Laconic kitchens are equipped with Bosch appliances, bathrooms are equipped with modern plumbing, built-in wardrobes and wardrobes are located in the bedrooms and corridors. Residents of the complex can take care of themselves in the wellness center with a 20m swimming pool, sauna and spa. You can spend your free time or have fun with your friends in the game room or watch a movie in the private cinema. For work, coworking, a zone with meeting and conference rooms, as well as a large hall for festive events was designed. 24-hour concierge service solves everyday problems. For young residents of the complex, a safe playground and a private school will be placed in the courtyard.

Facilities

- health Center
- 20 meter swimming pool
- sauna and spa
- movie
- game room
- living room
- event hall
- coworking space with meeting rooms
- private meeting rooms
- 2 acre park
- Sheldak Square
- landscape park
- playground
- 24 hour concierge service

Completion date: Q2 2023

Information updated: 21.06.2023

Photo gallery

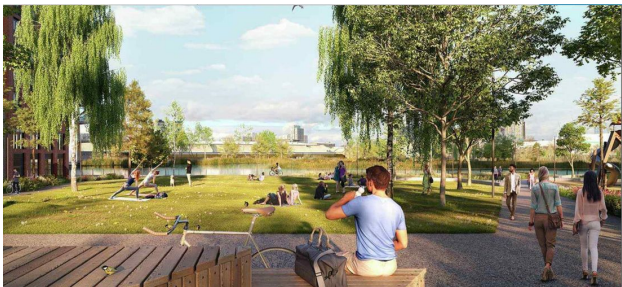
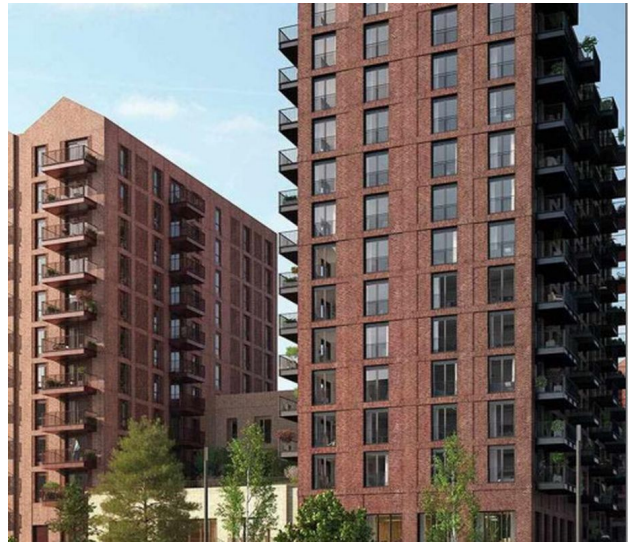

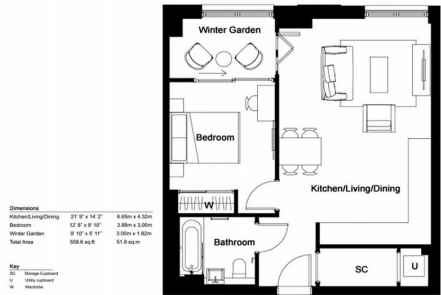
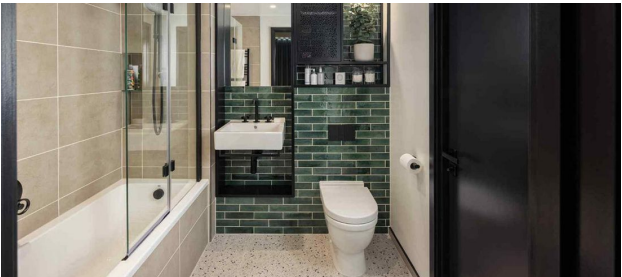
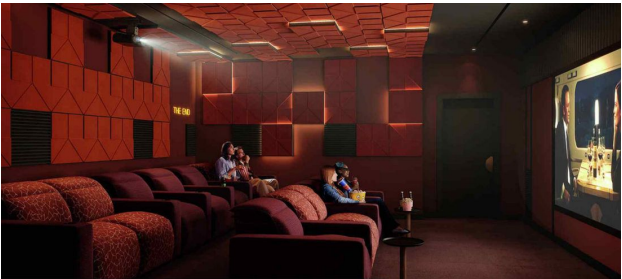



Scan the QR code to open the original page