







# Apartments in a new residential complex in the Kucukcekmece area with a rich social infrastructure (120345)



225 000 € - 1 270 200 €

 Floor area      42 m<sup>2</sup> - 184 m<sup>2</sup>

	<b>Studio</b>
 Number of rooms	<b>1 bedroom</b> <b>2 bedrooms</b> <b>3 bedrooms</b> <b>4 bedrooms</b>
 Furnitures	<b>Partly</b>
 To the beach:	<b>m</b>
 Location:	<b>Turkey, Istanbul</b>
 To the airport:	<b>km</b>
 To the city centre:	<b>km</b>

## Options

- ✓ View of the city
- ✓ Balcony/ Terrace
- ✓ Swimming pool
- ✓ Private territory
- ✓ Security
- ✓ Elevator
- ✓ Playground

## Description

A new residential complex rises in the European part of Istanbul, in the Kucukcekmece district. It is just a minute's walk from a metrobus stop and a 5-minute walk from the new Khawarai monorail that connects the metro station Seyrantepe with Vadistanbul.

Now is the best time to invest in one of the most promising projects in Istanbul. The residential project is built on a land area of 18,584 sq.m. and occupies a total building area of 73,721 sq.m. This construction site will house 11 houses with 390 individual apartments, 5 retail stores and various social infrastructure facilities for residents.

Apartment types range from 1 + 0 studios to spacious 4 + 1.

For a comfortable stay, all apartments are designed with built-in furniture, high ceilings, large windows and spacious balconies.

### **Apartment area:**

- Studios: 36- 42 sq.m.
- Apartments 1 + 1: 56- 117 sq.m.
- Apartments 2 + 1: 82- 138 sq.m.
- Apartments 3 + 1: 106-174 sq.m.
- Apartments 4 + 1: 178- 184 sq.m.

5 commercial units ranging from 183 to 275 sq.m.

A variety of social facilities on the territory and proximity to shopping centers, universities and public transport stops make this project an ideal place to live.

### **Facilities of the complex:**

- Pool
- Children's swimming pool
- Playground
- Indoor playground
- A fitness center
- SPA
- Athletic facilities
- Treadmills
- Cafeteria

### **Nearby are:**

- Metrobus stop
- Khawarai line

- 6 universities
- 7 hospitals
- 8 hotels
- 3 shopping malls

**Information updated: 07.01.2025**

## **Photo gallery**

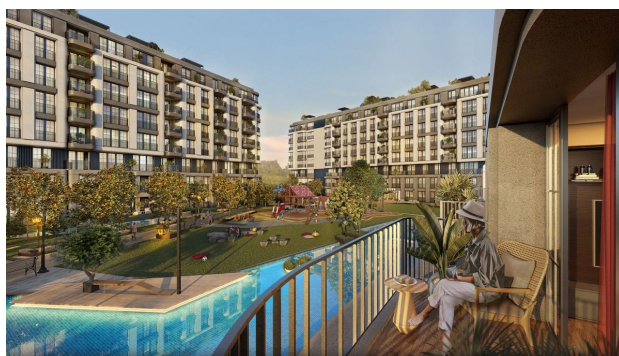





Scan the QR code to open the original page