





Luxurious apartment complex in the picturesque area of Tatlysu (006194)



250 000 € - 1 066 000 €

| | |
|--|---|
|  Floor area | 43 m² - 443 m² |
|  Number of rooms | 1+1 penthouse |
| | 2+1 penthouse |
| | 3+1 penthouse |
| | 5+1 penthouse |
| | garden-duplex 1+1 |
|  Furnitures | Partly |

 To the beach: **m**

 Location: **North Cyprus, Esentepe**

 To the airport: **km**

 To the city centre: **km**

Options

- ✓ Balcony/ Terrace
- ✓ Swimming pool
- ✓ Private territory
- ✓ 0% installment
- ✓ Security
- ✓ Playground

Description

An ideal location for luxury living and investment opportunities in Northern Cyprus.

The complex is located in the picturesque area of Tatlysu, offering breathtaking views of the Mediterranean Sea and the lush greenery of the region's mountains.

Spread on 80 hectares of first-class land on the first coastline, the complex offers an oasis of calm and comfort, where you can enjoy the warm sun and sea breeze.

The project is built with a "MOVE-IN READY" concept, offering a fully furnished property with modern kitchens and bathrooms, central air conditioning and card access for added security. The complex is divided into two phases, with a variety of property types to choose from, including luxury villas, spacious apartments and penthouses.

Our residents will have access to world-class amenities including a spa, gym, restaurant, tennis court, beach, laundry, housekeeping and beach cinema. The pools with water and light

show are ideal for relaxing evenings with family and friends. Cross-site services are also available through our partnership with eight other properties in Esentepe.

Together, we strive to provide our residents with exceptional pre-sales and after-sales services, including property management, rental services and 24/7 support for all property-related matters.

The complex with an attractive return on investment is an excellent choice for those who are interested in buying property in Northern Cyprus for investment purposes.

CONSTRUCTION PHASES

Consists of 2 construction phases.

Phase I: villas type V 5+1, apartments type A 1+1 and apartments type B 1+1.

Phase II: 2 and 3 bedroom type V bungalows, 1+1 type A apartments, 1+1 type B apartments with garden and 2+1 lotf type penthouses.

Maintenance, management and rental services of real estate.

Management company 24/7.

Information updated: 27.11.2023

Photo gallery







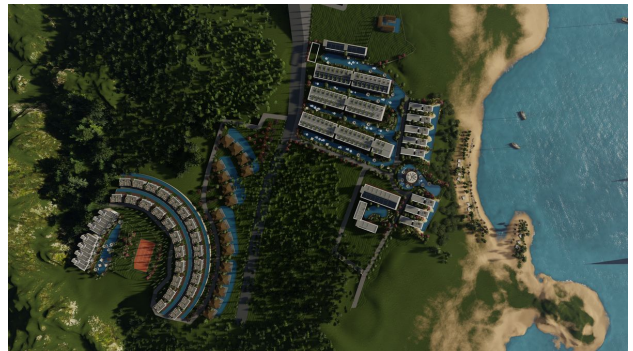



Scan the QR code to open the original page