







# Apartments in a residential complex from a developer in Oba (008252)



**204 000 € - 335 000 €**

-  Floor area **46 m<sup>2</sup> - 97 m<sup>2</sup>**
-  Number of rooms **1 bedroom**  
**2 bedrooms**
-  Furnitures **Partly**
-  To the beach: **2000 m**
-  Location: **Turkey, Alanya, Oba**
-  To the airport: **35 km**

 To the city  
centre:

5 km

## Options

- ✓ Balcony/ Terrace
- ✓ Swimming pool
- ✓ Private territory
- ✓ 0% installment
- ✓ Security
- ✓ Elevator
- ✓ Playground
- ✓ Generator

## Description

Both are an ideal area for those who want to enjoy the beauty of the Taurus Mountains and the Mediterranean Sea.

A luxurious residence with a rich infrastructure and cozy garden plots will provide you with a cozy and calm environment.

Choosing this complex, you will provide yourself with the feeling of living in the countryside, surrounded by ideal landscapes in a cozy area with beautiful nature.

To date, Oba is one of the most investment-attractive areas, as it is the most popular and in demand among buyers.

The complex will turn your ordinary life into its best version, where every moment of it will be filled with the pleasure of life itself and where your most incredible dreams will become a reality.

This is the real OBA...

The total area of the project is 4,000 m<sup>2</sup>, in close proximity to the Dymchay valley, the complex will accommodate 72 premium quality apartments.

The complex consists of 2 residential blocks and is suitable for those who choose premium luxury.

The residential complex will provide you with a view of the turquoise Mediterranean Sea and the majestic Taurus Mountains. Apartments equipped with a smart home system will provide you with the comfort and convenience of using the air conditioning and lighting system.

Life-changing comfort and luxury will not leave you even when you leave the apartment.

### **Infrastructure of the complex:**

- Pool
- Jacuzzi
- Indoor pool
- Gym
- Sauna
- Massage rooms
- Turkish hamam
- steam room
- Game room
- Electric generator
- Video surveillance system
- 24 hour security system
- Ramp for people with disabilities
- Parking
- Barbecue area

### **Layouts:**

- 1+1 area 46 m<sup>2</sup>
- 2+1 area 97 m<sup>2</sup>

Being in close proximity to the Waldorf Private School and only 5 minutes drive from the Dymcay River, only 2 km from the sea, and 5 km from the center of Alanya, you will live in close proximity to everything you may need.

Local shops, colorful boutiques, cozy cafes, luxurious restaurants offer you a wide choice options for everyday activities. One of the best private schools at your fingertips, providing a high level of education for your children from kindergarten to university. Distance to Antalya International Airport is 125 km away and Gazipasa International Airport is only 35 km away.

**THERE IS A POSSIBILITY OF INITIAL PAYMENT IN THE AMOUNT OF ONLY 20% OF THE COST OF THE CHOSEN APARTMENT AND INTEREST-FREE INSTALLMENTS UNTIL THE COMPLETION OF CONSTRUCTION.**

REGISTRATION OF TAPU IS PAID BY THE BUYER.

Completion date: 4th quarter 2024

**Information updated: 18.07.2024**

## Photo gallery

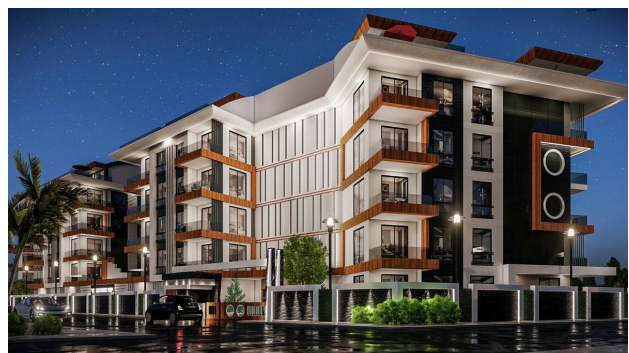







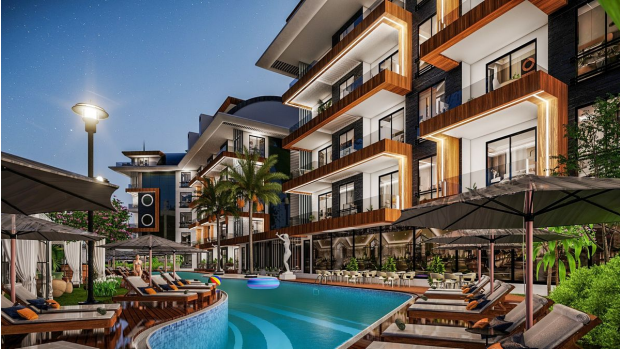

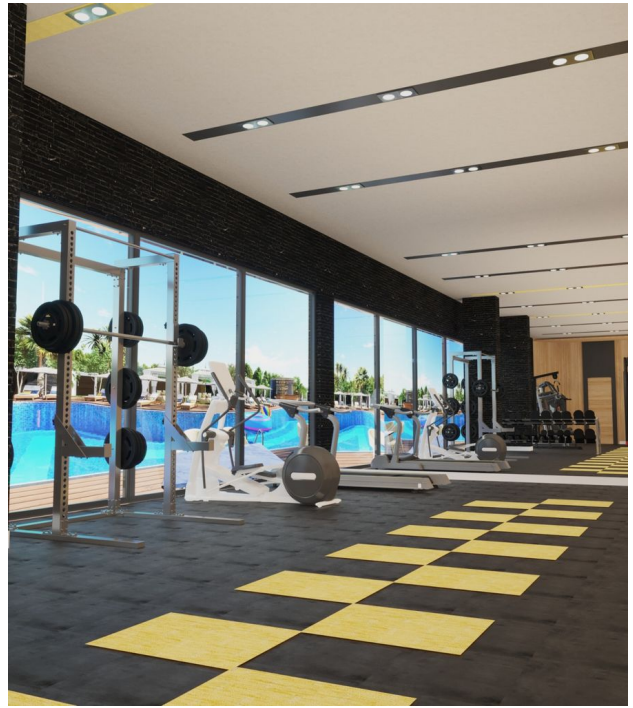



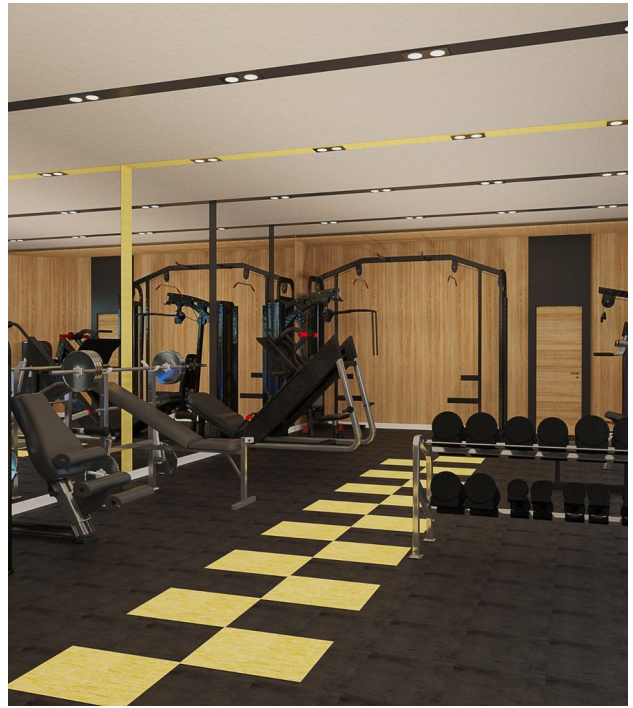













**BODRUM KAT PLANI**