

# Luxury residential complex in the Lapta area, near the tourist center of Northern Cyprus - Kyrenia (00393)



**232 518 € - 1 893 941 €**

**🏠** Floor area      **78 m<sup>2</sup> - 147 m<sup>2</sup>**

**🏠** Number of rooms      **1 bedroom**  
**5 bedrooms**  
**6 bedrooms**  
**2+1 penthouse**  
**3+1 penthouse**

**🪑** Furnitures      **Partly**

 To the beach: **m**

 Location: **North Cyprus, Kyrenia**

 To the airport: **km**

 To the city centre: **km**

## Options

- ✓ Sea view
- ✓ Mountain view
- ✓ Balcony/ Terrace
- ✓ Swimming pool
- ✓ Private territory
- ✓ 0% installment
- ✓ Security
- ✓ Playground

## Description

The project is located in the west in the Lapta region, a 22-minute drive to the tourist center of Northern Cyprus - Kyrenia.

The project consists of 152 apartments and 10 premium villas with breathtaking views of the sea and mountains.

The project is located close to the beaches of Sunas Beach Bar, Sardunia, Camelot, Lapta walking path, Merit hotels, etc.

The complex will have such infrastructure as a restaurant, 2 outdoor swimming pools, an indoor heated swimming pool, a mini-market, an office of the management company, a

children's playground, a mini water park, etc.

The project has 8 different types of housing, each type has been given a planet name according to their size.

Also within the complex, you can spend time with your loved ones in the Nova Center, which is located at the entrance to the project territory.

### **Object types:**

- 1+0 ground floor studios and penthouses (Mercury)
- 1+1 on the ground floor and penthouses (Mars)
- 2+1 on the ground floor and penthouses (Venus)
- 2+1 with linear pool on the ground floor and penthouses (Earth)
- 3+1 with infinity pool, ground floor and penthouses (Neptune)

### **Villa types:**

- Villas 5+2 (Saturn)
- Villas 6+2 (Jupiter)

The complex is an ideal place to stay in the pearl of the crystal clear Mediterranean Sea with indescribable views of sunsets and sunrises, combined with clean mountain air. Spacious layouts, modern architecture, large swimming pools, chic landscape design intertwined with incredible landscapes, an exclusive and liquid offer on the Northern Cyprus real estate market.

### **Infrastructure:**

- Outdoor infinity pool (875 m<sup>2</sup>)
- Outdoor swimming pool (250 m<sup>2</sup>)
- Mini water park
- Indoor heated pool
- Mini market
- Gym
- Sauna
- Restaurant/cafe
- Indoor play area

- Children's outdoor play area
- Beauty saloon
- Management company office
- Landscape design

### **Specifications:**

- Automatic central generator system for all common areas and homes
- Security and barrier system
- CCTV Cameras
- Reinforced concrete underground central water tanks
- Kitchen countertops made of Italian Lapitec stone in villas and apartments
- IP intercom in villas and apartments
- Equipped barbecue area in all villas and penthouses (except studio penthouses)
- Hisense multi-inverter air conditioning system in apartments
- Mitsubishi brand VRF air conditioning system in villas
- Jacuzzi in villas
- Infinity pool in villas
- Fireplace in villas
- Roof terrace and bar in villas
- Outdoor shower (next to the pool) in villas
- Italian stone countertop for villa washbasins
- Sauna in villas 5+2 and 6+2
- Laundry in villas 5+2 and 6+2
- Internal garden in villas 5+2 and 6+2
- Room in the basement in villas 6+2

### **Payment plan:**

- 35% down payment
- 30% interest-free installments until completion of construction
- 35% installment plan for 36 months after completion of construction

Construction start date: 03.2024

Construction completion date: 04.2027

**Information updated: 08.10.2024**

# Photo gallery

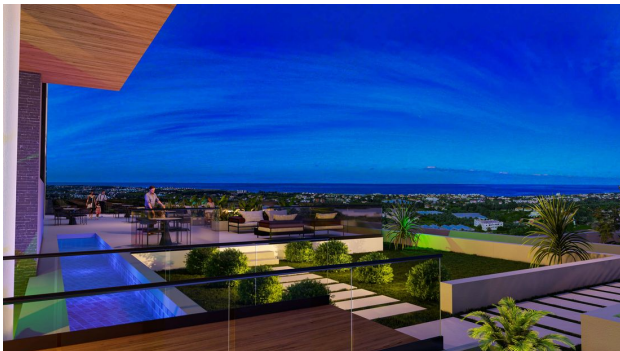





Scan the QR code to open the original page