



Apartments in a premium project on the first coastline (01757)



210 000 € - 450 000 €

-  Floor area **48 m² - 124 m²**
-  Number of rooms **1 bedroom**
garden-duplex 2+1
-  Furnitures **Partly**

 To the beach: **70 m**

 Location: **Turkey, Alanya, Kargicak**

 To the airport: **25 km**

 To the city centre: **15 km**

Options

- ✓ Sea view
- ✓ Balcony/ Terrace
- ✓ Swimming pool
- ✓ Outdoor parking
- ✓ 0% installment
- ✓ Security
- ✓ Forest view
- ✓ Elevator
- ✓ Playground
- ✓ Generator

Description

A new luxury premium project located in the east of Alanya in the Kargicak area, on the first coastline 70 m from the sea, on an area of 790 m².

From the windows of the apartments there will be a direct panorama of the sea on the south side and the coniferous forest on the north.

Within walking distance is a walking area with a clean and equipped embankment, well-maintained beaches, city infrastructure, cafes and parks.

The project consists of one block of 6 floors, 15 apartments:

- 1+1 area 48-54.2 m²
- two-level apartments 2+1 with access to the garden, area 117.3-123.6 m².

Comfort, modernity and attention to detail are what distinguishes the residential complex.

Location:

- Distance to Alanya center: 15 km
- Distance to sea: 70 m
- Distance to Gazipasa Airport: 25 km
- Distance to Antalya Airport: 140 km

Complex infrastructure:

- Outdoor adult and children's pools
- Covered parking area
- Generator
- 24/7 video surveillance

Specifications:

- According to the project, the interior walls of the apartments are finished with gypsum plaster and decorated suspended ceilings
- Porcelain stoneware flooring
- Double walls with sound-heat insulation
- Interior doors
- Armored entrance doors
- Double glazed windows
- Special finishing of external walls

Kitchen

- Built-in kitchen
- Granite countertop
- Ceramic floor covering

Bathroom

- Ceramic finishing of walls and floors
- Built-in furniture in bathrooms, washbasin, wall-hung toilet, shower cabin
- Boiler

Balcony

- Aluminum railings + glass
- Ceramic floors and outdoor lighting

Payment plan:

1+1

- 40% down payment
- 60% until completion of construction

2+1

- 30% down payment
- 70% until completion of construction

Start of construction: 30.11.2022

Completion of construction: 30.03.2024

Information updated: 09.08.2024

Photo gallery

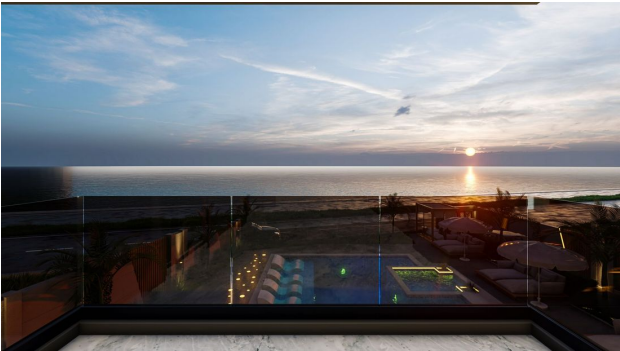

734 ADA 8 PARSEL



1./2./3. KAT PLANI

734 ADA 8 PARSEL



1. BODRUM KAT PLANI

734 ADA 8 PARSEL



ZEMIN KAT PLANI



Scan the QR code to open the original page