

Club complex of villas in the premium area of Bang Tao (128317)



982 277 € - 1 123 004 €

🏠 Floor area **428 m² - 494 m²**

🏠 Number of rooms **3 bedrooms**
4 bedrooms

🪑 Furnitures **Partly**

🌊 To the beach: **4000 m**

 Location: **Thailand, Phuket**

 To the airport: **20 km**

 To the city
centre: **km**

Options

- ✓ Sea view
- ✓ Balcony/ Terrace
- ✓ Swimming pool
- ✓ Private territory
- ✓ 0% installment
- ✓ Security
- ✓ Garden
- ✓ Elevator
- ✓ Playground

Description

Impressive villas with panoramic views.

The premium club village is located on a picturesque slope surrounded by mountain peaks and tropical forests.

Each villa enjoys fantastic panoramic views thanks to its unique location. The unique architectural code of the village is designed in complete harmony with the surrounding natural landscape.

Description of the object

In the complex: a total of 58 villas of various layouts and types with swimming pools. The size of the plots is 60 square meters with spacious villas up to 493 sq.m. with 4 bedrooms and 428

sq.m. with 3 bedrooms.

The complex provides health and recreation services, including massage, fitness, yoga, sauna, play and children's areas, a workshop and a cafe.

The villas are located just minutes from beaches, ports, golf clubs and other entertainment centers, providing easy access to Phuket's rich infrastructure.

In the villa: the interiors of the villas are presented with a modern design that combines functionality and aesthetics.

Bright, open spaces that blend harmoniously with panoramic views and create a cozy atmosphere.

Spacious terraces and panoramic windows providing stunning views of nature and the surrounding landscape create a feeling of unity with the surrounding nature.

The **Type A villa** option offers 4 bedrooms, 5 bathrooms, 1 multifunctional room, 2 parking spaces, Thai kitchen, living rooms, swimming pools and spacious terraces.

The **"Type B" villa** option has 3 bedrooms, 4 bathrooms, multifunctional rooms, also with swimming pools and outdoor terraces. The ground floor includes a foyer, semi-open dining Thai kitchen, maid's quarters, laundry room, living room, bathroom, multi-purpose room opening to the garden, elevator and mezzanine. The second floor consists of bedrooms, bathrooms and an open terrace with access to the garden. The third floor includes a kitchen, living room, pool, pool room, bathroom and outdoor terrace.

Feature: The project reflects its prime location and panoramic views spanning a total development area of 25,600 sq.m.

The developer has created a unique space of villas with private pools, providing its clients with the highest level of luxury.

This complex is located in the picturesque area of Choeng Thale. Comfort and infrastructure are combined here. In addition, the complex offers unique recreational opportunities with a natural swimming pool and 24/7 security, ensuring safety and peace of mind for all residents.

Description:

- Delivery: 2026

- To the sea: 4 km
- Bedrooms: 3 - 4
- Bathrooms: 4 - 5
- Living area: 428 - 494 m²
- Plot area: 60 - 121 m²
- Pool area: 22 - 22 m²
- Income: Actual rental income
- Installment plan: Installment payments for the construction period
- The price includes: finishing, plumbing, built-in kitchen, built-in wardrobes, air conditioning, alarm, telephone line, landscaping
- Not included: furniture package

Location:

- Airport 20 min
- Patong 20 min
- Shopping center 3 min
- Supermarket 3 min
- Restaurants 5 min
- Hospital 20 min
- Golf club 10 min
- Yacht club 25 min

Information updated: 08.02.2024

Photo gallery





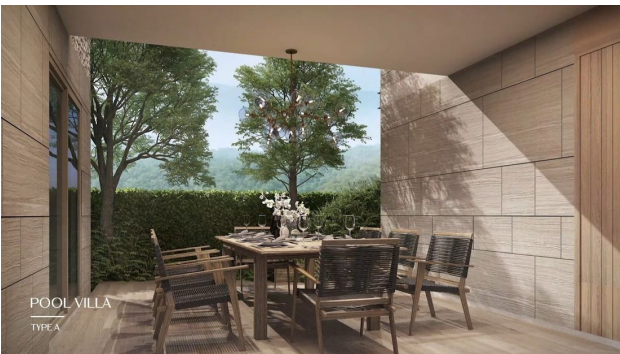
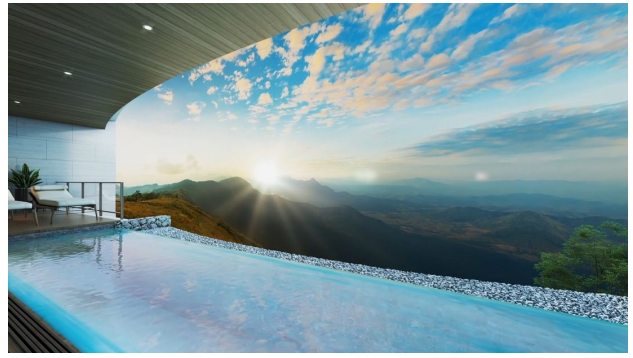





Scan the QR code to open the original page