

# Premium class apartments in Phuket on Bang Tao beach (131317)



**217 152 €**

**🏠** Floor area      **57 m<sup>2</sup> - 235 m<sup>2</sup>**

**🏠** Number of rooms      **1 bedroom**  
**2 bedrooms**  
**3 bedrooms**  
**4 bedrooms**

**🛋️** Furnitures      **Partly**

 To the beach: **50 m**

 Location: **Thailand, Phuket**

 To the airport: **25 km**

 To the city centre: **km**

## Options

- ✓ Sea view
- ✓ Balcony/ Terrace
- ✓ Swimming pool
- ✓ Private territory
- ✓ 0% installment
- ✓ Security
- ✓ Garden
- ✓ Underground parking
- ✓ Playground

## Description

This complex includes 141 premium class residences, a Wellness center and a 5\* hotel and will become a unique luxury wellness destination, occupying more than 122,000 sq.m.

Magnificent parks, lakes and gardens will occupy 70% of the area of this project and will be its distinctive feature. A huge advantage is the unique location for residential real estate on the island. Phuket complex is located just **50 m from the beach.**

### Description of the object

The internal closed infrastructure of the complex will include - restaurants and bars, an infinity pool overlooking the coastal beauty, specially recreated reservoirs on the territory of the complex called "Blue Lagoon", a club house, a children's club, a gym, a business center, its own shops and supermarkets, restaurants on the lakes.

Everywhere in the complex there will be the green luxury of the Gardens of Eden. Total 51,296 sq.m. parks and gardens, of which 7,922 sq.m. lakes and ponds and 10,608 sq. m. are reserved for swimming pools.

Each residential building has underground parking, and the area is safe and free from traffic, thanks to a closed and guarded perimeter.

**In the apartments:** apartments with ceilings over 3 meters high, private swimming pools, terraces with sea views and internal gardens. You can choose from **1, 2 and 3 room apartments, as well as 3 and 4 room** penthouses and duplexes with an area of up to 235 sq. m. meters.

All residences are designed to be world class. All interior interiors and common spaces of this complex were made with the participation of the White Jacket studio from Singapore. This studio is known for its experience in world-class hotel design (Naumi Hotel, JW Marriott, Rosewood Hotel Ningbo in China and Kimpton Naranta Bali).

**Feature:** This residence promises you the highest quality of relaxation. The creation and management of this project is carried out by a professional team: Ravi Chandran (president of the Banyan Tree Group and managing director of Laguna Phuket), Martin Palleros (Argentine architect who designed premium projects in Phuket - Twin Palms Residences Mont Azure and Anantara Beach House), etc. .

## **Object details**

- Delivery: 1st phase, 4th quarter of 2026
- To the sea: 50 m
- Bedrooms: 1 - 4
- Bathrooms: 1 - 4
- Living area: 57 - 235 m<sup>2</sup>
- Income: actual rental income, rental program up to 5 years.
- Installment plan: installment payments until construction is completed

- The price includes: finishing, plumbing, built-in kitchen, built-in wardrobes, air conditioning
- The price does not include: furniture project

### **Location:**

- Airport 25 min
- Patong 44 min
- Shopping center 12 min
- Supermarket 10 min
- Restaurants 5 min
- Hospital 7 min
- Golf club 5 min
- Yacht club 15 min

**Information updated: 08.02.2024**

## **Photo gallery**



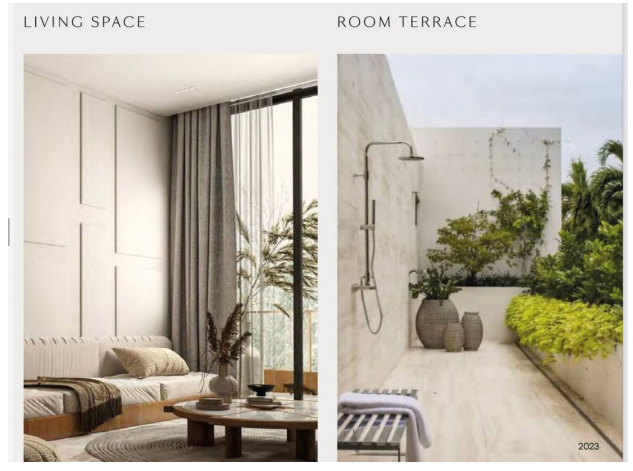
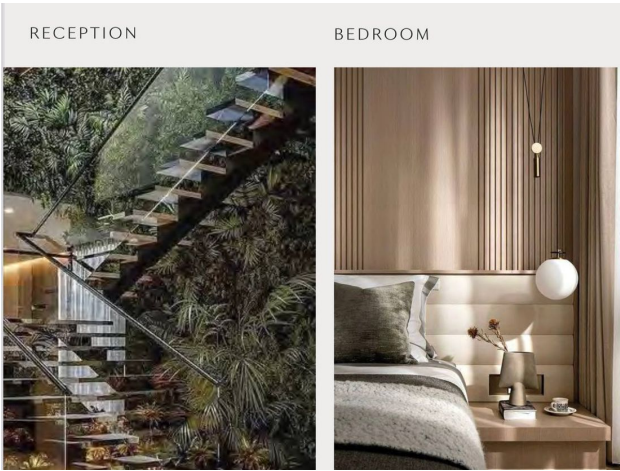



Scan the QR code to open the original page