

Apartments with a unique design in a new residential complex in the Boaz area (001499)



159 091 € - 559 441 €

🏠 Floor area **65 m² - 210 m²**

🏠 Number of rooms
1 bedroom
2 bedrooms
3 bedrooms

🪑 Furnitures **Partly**

🌊 To the beach: **600 m**

 Location: **North Cyprus, Boaz**

 To the airport: **km**

 To the city
centre: **km**

Options

- ✓ Warm floor
- ✓ Balcony/ Terrace
- ✓ Swimming pool
- ✓ Private territory
- ✓ 0% installment
- ✓ Security
- ✓ Playground
- ✓ Generator

Description

The complex is located in Boaz, 600 meters from the sea.

On the territory of the complex there is a restaurant, bar, children's playground, swimming pools, sauna, gym, beauty salon.

Nearby is a complex of bicycle and pedestrian paths, a marina, casinos, schools, kindergartens, universities, shops, restaurants, bars, nightclubs, barbecue areas, beaches, water parks.

The complex offers types of housing:

- apartment 1+1
- apartment 2+1
- 3 bedroom villas

The apartments feature a modern and unique design and high quality interiors that are ideally suited to their location.

Highlights include ceramic flooring, built-in walk-in showers, upper floor terraces, granite kitchen countertops, heated floors, luxury wood finishes, wall-mounted wardrobes in all bedrooms, built-in discreet cooling systems in ceilings, double glazed windows. Additional design package.

Description of the apartments:

1+1 penthouses

- living area: 65.00 m²
- Balcony: 17.00 m² + full roof terrace 65.00 m²
- Bathroom: 1
- Bedroom: 1
- Parking space: 1

2+1 apartments

- living area: 80.00 m²
- Balcony: 6.00 m²
- Private garden 15.00 m²
- Bathroom: 1
- Bedrooms: 2
- Parking space: 1

Villa

Ground floor

- bathroom = 6.09 m²
- staircase = 12.36 m²
- entrance terrace= 5.65 m²
- hallway = 7.77 m²
- bedroom = 15.05 m²
- living room\kitchen= 53.75 m²

Total 100.67 m²+ Garden = 43.35 m² + BBQ terrace = 36.74 m²

1st floor

- bathroom = 6.09 m²
- staircase = 12.36 m²
- wardrobe = 5.94 m²
- bedroom = 12.50 m²
- terrace = 4.18 m²
- terrace = 25.70 m²
- bedroom = 14.55 m²
- office = 8.04 m²
- bathroom = 5.36 m²
- terrace = 3.50 m²

Total 98.22 m²+ roof terrace = 85 m²

Payment plan:

1. 35% - first payment
35% - before receiving the keys, until 2026
30% - installments for a year after receiving the keys
2. 35% first payment, 65% until completion of construction **(2% discount)**

Construction completion date: 06.2026

Information updated: 09.08.2024

Photo gallery









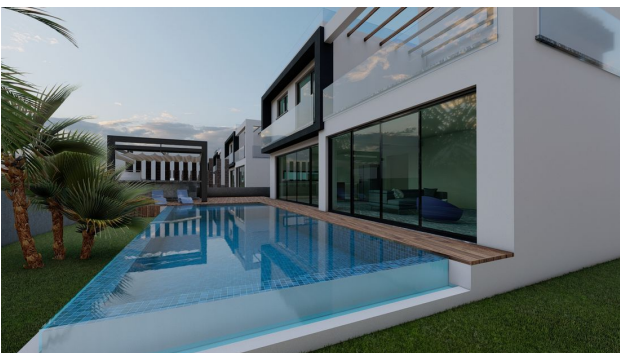





Scan the QR code to open the original page