







# New modern apartments near the beach in Calpe (163237)



# 540 250 €

 Floor area	<b>98 m<sup>2</sup></b>
 Number of rooms	<b>3 bedrooms</b>
 Furnitures	<b>Partly</b>
 To the beach:	<b>m</b>
 Location:	<b>Spain, Аликанте</b>
 To the airport:	<b>km</b>
 To the city centre:	<b>km</b>

## Options

- ✓ Balcony/ Terrace
- ✓ Swimming pool
- ✓ Private territory
- ✓ Security
- ✓ Elevator
- ✓ Playground

## Description

Ideally located just 400 meters from the beach in Calpe, these new modern apartments represent a unique offer for those who value a combination of style, comfort and proximity to essential amenities.

### Description of the apartment:

- Bedrooms: 3

- Bathrooms: 2
- Living rooms: 1
- View: sea
- Kitchen: American - furnished without appliances. tech.
- Usable area: 87 m2
- Built area: 98 m2
- Terrace: 15 m2
- Floor number: 15

Two 15-storey buildings provide magnificent views of the salt lakes and the Ifach rock.

The choice of finishing materials is yours, giving you the opportunity to create an interior that reflects your style and preferences.

Each apartment is equipped with an armored entrance door, premium ceramic tiles, climalit double-glazed windows, video intercom, TV antenna, telephone and Internet wiring, built-in wardrobes and air conditioning.

**The complex's common areas provide extensive gardens, a swimming pool, a tennis court, a gym and a common space with sea views. Each building has its own public area, including a terrace on the 9th floor.**

Each apartment also comes with a parking space and a storage room.

These apartments are the perfect combination of modern design, amenities and a great location, providing a unique opportunity to create your ideal home in sunny Calpe.

**Information updated: 28.10.2024**

## **Photo gallery**



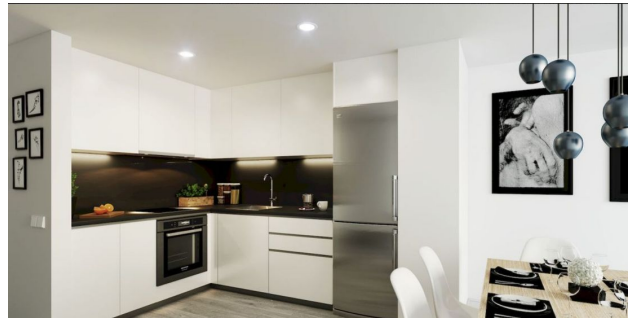
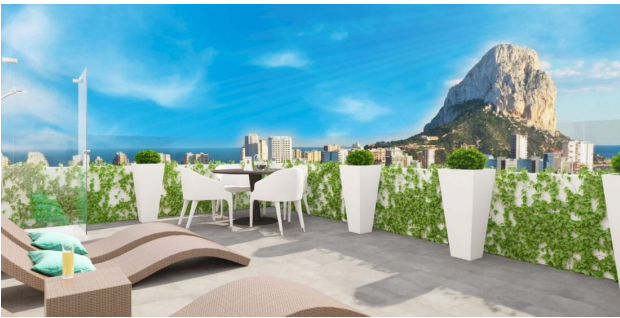

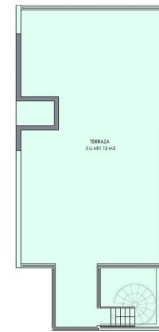
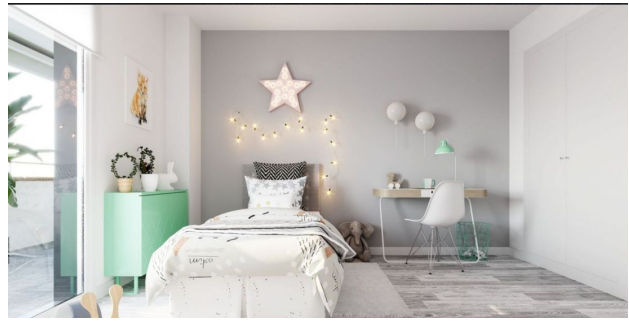

ESCALA GRAFICA  
0M 10M 20M 30M 40M 50M

VIVENDA 1.15.3			
Superficie util	Superficie intermedia	Superficie terrace	Superficie total
104,44 m <sup>2</sup>	104,44 m <sup>2</sup>	104,44 m <sup>2</sup>	104,44 m <sup>2</sup>

1.15.3



Scan the QR code to open the original page