

# Apartment in an exclusive residential complex in the new sector of Benalua Sur (035237)



**344 500 €**

-  Floor area **94 m<sup>2</sup>**
-  Number of rooms **3 bedrooms**
-  Furnitures **Partly**

 To the beach: **m**

 Location: **Spain, Аликанте**

 To the airport: **km**

 To the city centre: **km**

## Options

- ✓ Sea view
- ✓ Balcony/ Terrace
- ✓ Swimming pool
- ✓ Private territory

## Description

Exclusive residential complex located in the new sector of Benalua Sur, on a plot closest to the city center and close to the golden mile of Alicante.

This avant-garde project offers modern 2, 3 and 4 bedroom apartments, as well as a gym and an incredible terrace with infinity pool, offering stunning views of the sea and Alicante skyline.

### Main characteristics:

- **City:** Alicante (Alacant)
- **Area:** Benalua
- **Number of bedrooms:** 3
- **Number of bathrooms:** 2
- **Area:** usable - 80 m<sup>2</sup>, built-up - 94 m<sup>2</sup>
- **Floor:** 2
- **Terrace:** 7 m<sup>2</sup>

### Description of the apartment:

The apartment has a modern design and high quality materials and finishes. Spacious and bright rooms create a comfortable atmosphere for living. The apartment has an American kitchen, equipped with everything necessary for preparing delicious meals.

The residential complex offers a wide range of services for the convenience of residents. You will be one step away from the Alicante promenade, where you can enjoy walks and sea air. A high level of internal comfort is achieved thanks to the most modern insulation and air conditioning systems.

**Additional amenities:**

- **Gym:** to maintain an active lifestyle
- **Leisure terrace:** with infinity pool overlooking the sea and the Alicante skyline
- **Parking space and storage room:** included in the price
- **Unfurnished:** yes

Year of construction: 2024

This residential complex offers a unique opportunity to live in modern and comfortable accommodation in the center of Alicante, with access to all necessary services and amenities.

Taxes are not included in the price.

**Information updated: 10.06.2024**

## **Photo gallery**

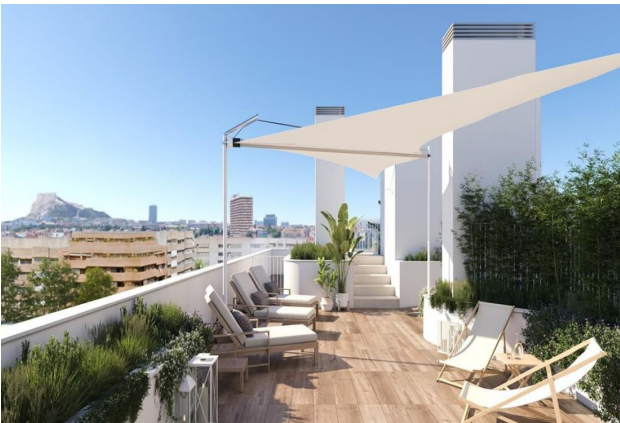

**Portal 1. P1-B 3D**

**Superficies:**

- Superficie útil: 80,24 m<sup>2</sup>
- Superficie construida: 84,20 m<sup>2</sup>
- Superficie construida en planta: 84,20 m<sup>2</sup>
- Superficie construida máxima: 200,00 m<sup>2</sup>

**Localización**

0 10m 20m 30m 40m 50m

Características técnicas en verde

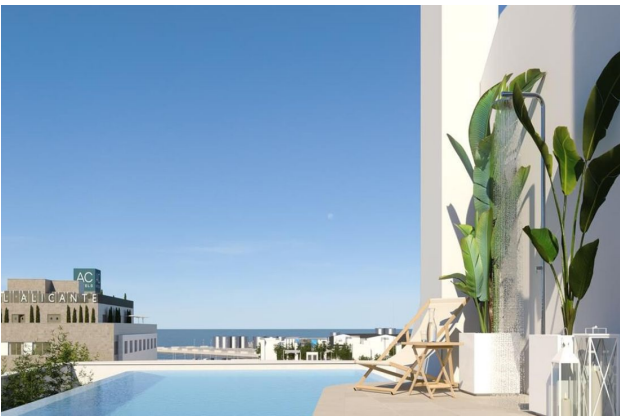







Scan the QR code to open the original page