







# Apartment in an exclusive residential complex on the main Habaneras Avenue in Torrevieja (054237)



**265 000 €**

-  Floor area **114 m<sup>2</sup>**
-  Number of rooms **3 bedrooms**
-  Furnitures **Partly**
-  To the beach: **300 m**
-  Location: **Spain, Torrevieja**
-  To the airport: **km**

 To the city  
centre:

km

## Options

- ✓ Balcony/ Terrace
- ✓ Swimming pool
- ✓ Private territory

## Description

Exclusive residential complex located on the main Habaneras Avenue in Torrevieja, in a privileged location, **just 300 meters from the best beaches** and close to all amenities: restaurants, cafes, supermarkets and the Cultural Activities Center.

8 minutes walk from the bus station and the center of Torrevieja, this area is one of the best places to live or invest with a future perspective.

The main avenue connecting the city center with the beaches will soon become a pedestrian alley where you can stroll along the entire coastline, breathing fresh air and listening to the crashing waves of the sea.

The residential complex consists of 56 apartments with 1, 2 and 3 bedrooms and 2 bathrooms, offering a variety: duplexes, penthouses with solarium, large terraces with stunning panoramic sea views or private terraces on the ground floors with direct access to common areas.

All homes have dual orientation to ensure cross ventilation and natural air, as well as an east and south orientation to ensure sunlight throughout the home.

**Property type:** Apartment

**Location:** Torrevieja

**Bedrooms:** 3

**Bathrooms:** 2

**View:** Outdoor

**Cuisine:** American

**Usable area:** 94 m<sup>2</sup>

**Built-up area:** 114 m<sup>2</sup>

**Year of construction:** 2025

**Terrace:** 20 m<sup>2</sup>

This residential complex in Torrevieja is ideal for year-round living, enjoying the tranquility of the beaches and all the services the city offers.

**Information updated: 28.06.2024**

## Photo gallery

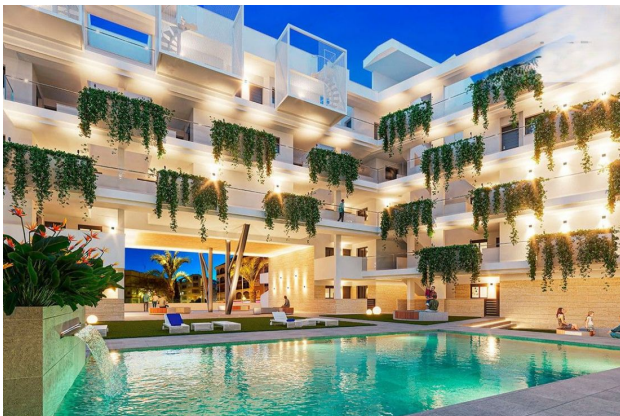





SUPERFICIES ÚTILES	
Distribuidor	8,95 m <sup>2</sup>
Dormitorio 1	10,00 m <sup>2</sup>
Dormitorio 2	8,50 m <sup>2</sup>
Dormitorio 3	11,65 m <sup>2</sup>
Baño 1	3,65 m <sup>2</sup>
Baño 2	3,65 m <sup>2</sup>
Vestíbulo	1,50 m <sup>2</sup>
Salón-comedor	23,35 m <sup>2</sup>
Cocina	8,90 m <sup>2</sup>
Terraza acceso	5,40 m <sup>2</sup>
Terraza Azuis	14,80 m <sup>2</sup>
<b>TOTAL</b>	<b>100,15 m<sup>2</sup></b>

SUPERFICIE CONSTRUIDA	
Vivienda	95,60 m <sup>2</sup>
Terraza	20,20 m <sup>2</sup>
<b>TOTAL</b>	<b>115,80 m<sup>2</sup></b>

VIVIENDA: 21





Scan the QR code to open the original page