

Modern apartments with short-term rental income in Muratpasa area (020322)



116 000 € - 306 000 €

- 🏠 Floor area** **57 m² - 116 m²**
- 🏠 Number of rooms** **1 bedroom**
2+1 penthouse
- 🪑 Furnitures** **Full**

 To the beach: **1100 m**

 Location: **Turkey, Antalya**

 To the airport: **14 km**

 To the city centre: **km**

Options

- ✓ White goods
- ✓ Furniture
- ✓ Balcony/ Terrace
- ✓ Private territory
- ✓ Outdoor parking
- ✓ Elevator
- ✓ Generator

Description

Modern residential complex in Antalya, Muratpasa district.

A project that generates income from short-term rentals.

The complex offers apartments with high investment potential, located in one of the best locations in Antalya, just 1 km from the sea.

Due to its location within walking distance of all infrastructure, including parks, shops, restaurants and the historical Kaleici district, the complex provides high rental yield.

Main characteristics of the complex:

- Plot area: 624 m²
- Total construction area: 5200 m²

- Number of floors: first + 6

Apartments:

- 43 apartments 1+1
- 9 duplexes 2+1

Location:

- Antalya International Airport 14 km
- Old Town Yacht Marina 2 km
- Lara beach 17 km
- shopping center 1.5 km
- 5 minutes walk to the historical site
- hospital 1 km
- retro tram line 2 minutes
- beach 1.2 km

Unique advantages:

- Walking distance to historical and cultural places
- Proximity to shopping centers and the sea
- Modern standards of quality and comfort
- High rental potential

Infrastructure and amenities:

- Two-story underground parking for 19 cars
- 2 elevators on each floor
- Reception area and lobby at the entrance to the building
- 24-hour security and video surveillance
- Generator
- Fire extinguishing system including fire pumps and fire water tank
- Smoke extraction fans and emergency lighting
- Fire escape

Apartment interior:

Kitchens:

- 1+1 apartments have a kitchen combined with a living room
- 2+1 apartments have a separate kitchen
- Custom Design Kitchen Cabinets
- Built-in appliances: FRANKE, TEKA or BOSCH, electric built-in oven, glass hob with 4 burners, extractor hood
- Faucets: ECA, CREAVIT or VITRA
- New generation tabletop
- Porcelain stoneware floors
- Spot lighting

Bathrooms:

- 1+1 apartments have one bathroom
- 2+1 apartments have two bathrooms
- Special design of bathroom cabinets
- Faucets: ECA, CREAVIT or VITRA
- Plumbing ware ARTEMA, CREAVIT, BOCCI or SEREL
- Porcelain stoneware floors: KÜTAHYA CERAMIC or VITRA
- Spot lighting
- Shower trays HÜPPE, DELTA, CABINET or VITRA
- Glass shower cabin

General characteristics:

- Laminate floor
- Windows with PVC profile
- Porcelain stoneware floors
- Heating: air conditioning, combi boiler
- Cooling: air conditioning
- In apartments 2+1 - children's room
- Entrance doors: steel doors brand TEPE SAFE or equivalent
- Door locks: YALE, KALE or ITO brand
- Windows and balcony doors: REHAU, EGEPEN, PAKPEN or equivalents

Terms of payment:

- Down payment: 50%

- Balance: installments until project completion

Construction completion date: 09.2025

This complex offers unique advantages and ideal conditions for living and investment.

Living in this complex means enjoying the magic of the past and the comfort of the future, breathing in the atmosphere of historical Kaleici and the modern rhythm of the city of Antalya.

Information updated: 10.07.2024

Photo gallery

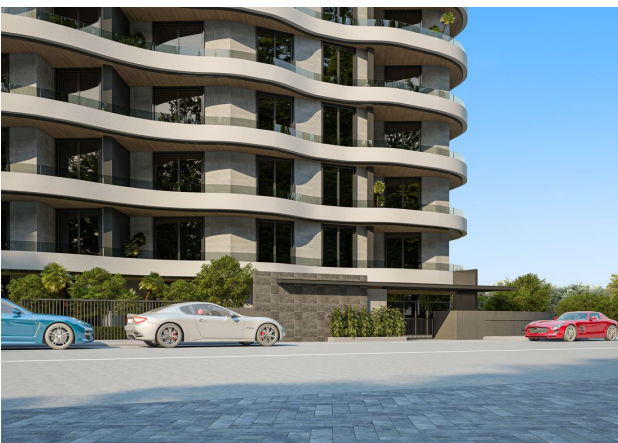





Scan the QR code to open the original page