

Spacious apartments in the premium area of ☒☒Bang Tao (026317)



164 937 € - 542 000 €

🏠 Floor area 39 m² - 105 m²

**🏠 Number of rooms 1 bedroom
2 bedrooms**

🪑 Furnitures Full

🌊 To the beach: 2000 m

📍 Location: Thailand, Phuket

✈️ To the airport: 16 km

 To the city
centre: km

Options

- ✓ Furniture
- ✓ Balcony/ Terrace
- ✓ Swimming pool
- ✓ Private territory
- ✓ Garden
- ✓ Elevator
- ✓ Playground

Description

A new condominium from a well-known Thai developer **in the Bang Tao** area offers unique opportunities for comfortable living and high-yield investment.

Located just 2 km from the sea, the complex is located in the prestigious Laguna area, close to golf courses, restaurants, shops and the popular shopping street Boat Avenue.

This location guarantees a high level of comfort and convenience, as well as excellent rental for investors.

The project includes 5 residential buildings from 5 to 7 floors and one building for parking.

There are only 175 apartments in the complex, each of which is made in soft natural tones, creating an atmosphere of comfort and harmony.

Spacious balconies and elegant interiors with smooth shapes help residents feel a close connection with the surrounding nature.

The apartments offer a choice **of 1 and 2 bedroom apartments**, as well as penthouses. **The area varies from 39 to 105 m².**

All apartments are delivered finished, with a built-in kitchen, wardrobes, plumbing, air conditioning and furniture.

The project is scheduled for completion **in Q1 2026**, with the possibility of an installment plan until the end of construction.

The complex offers a variety of recreation areas, including two swimming pools, children's and family playgrounds, a fitness center, barbecue terraces and a golf simulator. The main concept is harmony with nature and the creation of an oasis for relaxation.

Key infrastructure facilities near the complex:

- Airport - 16 km
- Shopping center - 1 km
- Supermarket - 50 m
- Restaurants - 50 m
- Hospital - 7 km
- Golf club - 3 km
- Yacht club - 12 km

The perfect combination of comfort, amenities and harmony with nature makes this project attractive for both living and investment.

Information updated: 12.09.2024

Photo gallery

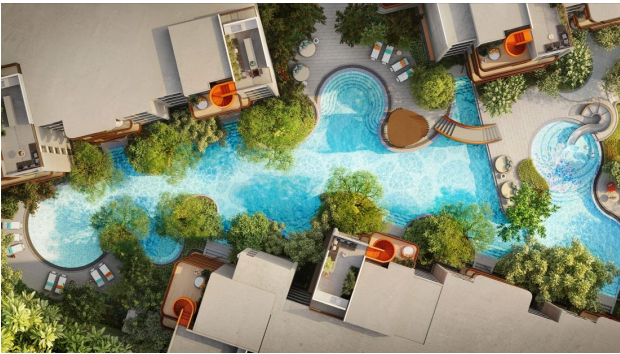
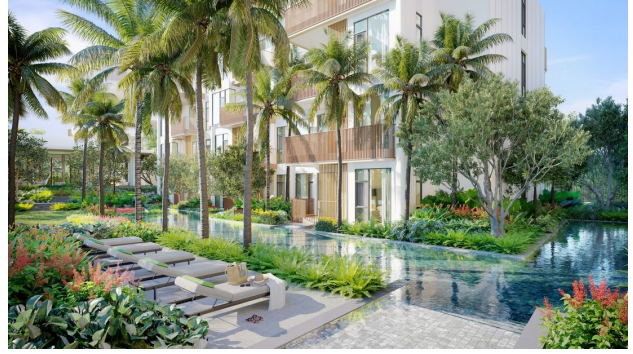



Scan the QR code to open the original page