







Luxury apartment in a new complex in Benidorm, next to the IMED hospital (238237)



260 000 €

 Floor area	88 m²
 Number of rooms	2 bedrooms
 Furnitures	Partly
 To the beach:	m
 Location:	Spain, Benidorm
 To the airport:	km
 To the city centre:	km

Options

- ✓ Balcony/ Terrace
- ✓ Swimming pool
- ✓ Private territory
- ✓ Underground parking
- ✓ Elevator
- ✓ Playground

Description

Luxury apartment in a new tower located in Benidorm, opposite the IMED Levante hospital.

The apartment is located in a modern residential complex with excellent infrastructure: on the territory there is a communal swimming pool, beautifully decorated recreation areas, gardens, a solarium and a children's playground.

The apartment includes **2 spacious bedrooms, 2 bathrooms, a furnished kitchen**, as well as a large bright terrace of 18 m², which offers beautiful views.

The total **area** of the apartment is **88 m²**, of which the usable area is 70 m².

The apartment is located on the **2nd floor of the building**.

Completion of construction in 2025.

The construction will be carried out using high-quality materials.

The price includes an underground **garage and a storage room**, as well as a centralized air conditioning system.

The building has a lift and a laundry room. The complex is energy efficient and has modern amenities.

The distance to the sea is only 8 minutes, **the hospital is located 100 meters from the house**, which makes this offer especially convenient for families.

Do not miss the chance to buy a home in one of the most prestigious areas of Benidorm!

Information updated: 11.10.2024

Photo gallery

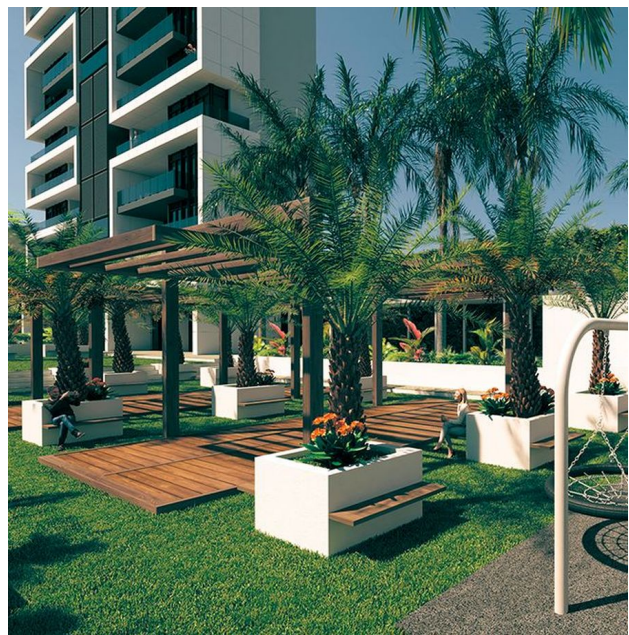

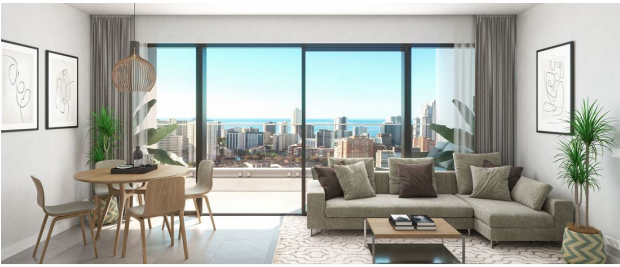

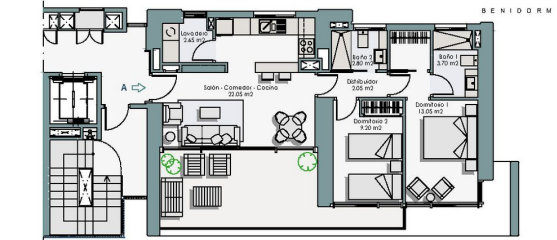

Bando Gráfico

0m 1m 2m 3m 4m 5m 6m

Vivienda Tipo 3A

Plantas: 25,54,48,74,124,154,184,194

Superficie construida interior de vivienda:	70,75 m ²
Superficie construida terraza exterior:	15,82 m ²
Superficie construida elementos comunes:	32,57 m ²
Superficie construida total:	129,14 m ²
Superficie útil de la vivienda:	99,14 m ²

TIPO 3

Las superficies que se promueven en este plano y en la Memoria son aproximadas, los detalles serán los que surjan de la ejecución de la obra. Se hace entrega de la vivienda así como el mobiliario y electrodomésticos que constan en el anexo de equipos.
 El acceso de altura y el emplazamiento de los balcones puede sufrir ligeras variaciones en función del estado definitivo. Esto puede llegar a producir modificaciones de carácter menor.