

Project in Avsallar. Sea view from all apartments! (01314)



140 000 € - 340 000 €

🏠 Площа **44 м² - 180 м²**

1 спальня

🏠 Кімнат

2 спальні

2+1 пентхаус

3+1 пентхаус

🪑 Меблі

Частково

🌊 До моря:

850 м

📍 Локація:

Туреччина, Аланія, Авсаллар

✈ До аеропорту: **66 км**

 До центру
міста:

24 км

Опції

- ✓ Вид на море
- ✓ Вид на гори
- ✓ Вид на город
- ✓ Балкон/Тераса
- ✓ Басейн
- ✓ Розтермінування під 0%
- ✓ Дитячий майданчик
- ✓ Генератор

Опис

The residential complex with chic infrastructure is located in the picturesque area of Alanya - Avsallar. Thanks to a good choice of land, absolutely from all apartments offers a stunning view of the Mediterranean Sea, the city and the Taurus Mountains. Avsallar is an elite area located just 20 minutes from the center of Alanya, between the Taurus Mountain Range and the Mediterranean Sea.

In Avsallar choose accommodation for a comfortable stay and for a full rest. There are sandy beaches with gentle entrance to the sea, developed urban infrastructure, clean air thanks to the pine trees growing here.

The residence will be located on a plot of land of 4266 m², will consist of one 9-storey block, which will accommodate 90 apartments of various plans. To the famous beach Inzhekum only 850 meters. Within walking distance all the developed infrastructure of the city - restaurants, markets, markets, pharmacies, parks.

Infrastructure of the complex:

- Outdoor pool
- Heated pool
- Water park
- Locker rooms
- Hamam
- Sauna
- Roman couple
- SPA
- Salt room
- Massage rooms
- Game room
- Children's playroom
- Council room
- Showers
- Fitness
- Cafe/Restaurant
- Barbecue space
- Summerhouse
- Outdoor parking
- Power generator
- Satellite TV and Internet
- Guarding

In apartments:

- Floors - ceramic tiles
- Walls - water-based paint
- PVC windows with double glazing
- TV and telephone cables
- Main and secondary lighting
- Sliding balcony doors

Location:

- To Gazipasa Airport - 66 km
- From the center of Alanya - 24 km

- To the center of Antalya - 144 km

Construction dates: November 2021 - December 2022. With an initial contribution of 50% 0% is granted until the completion of the construction, which will allow you to avoid large one-time expenses.

A great choice for those who appreciate luxurious lifestyle and at the same time private, delicate pastime!

Price updated: 24.07.2024

Фотогалерея



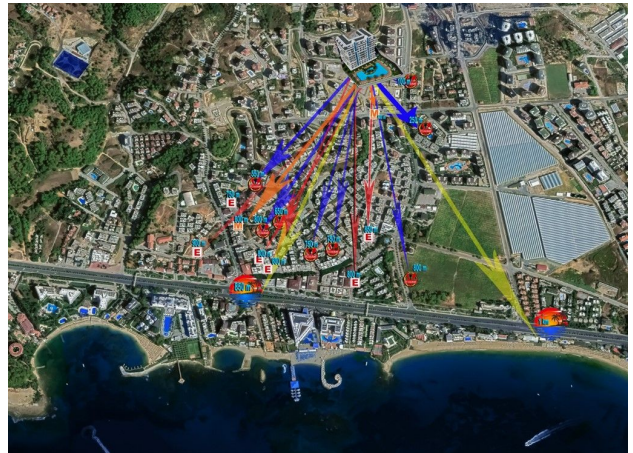



BODRUM KAT PLANI

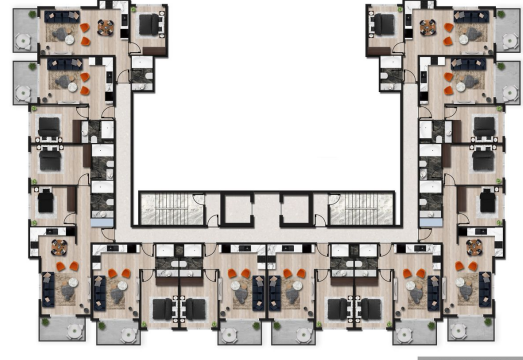

NORMAL KAT PLANI

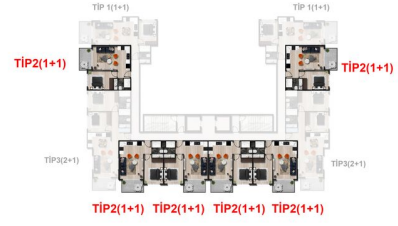
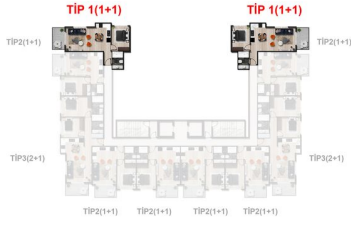

1+1 DAİRE PLANI
BRÜT=55 m2

TİP 1 (1+1) PLANI



1+1 DAİRE PLANI
BRÜT=50 m2

TİP 2 (1+1) PLANI

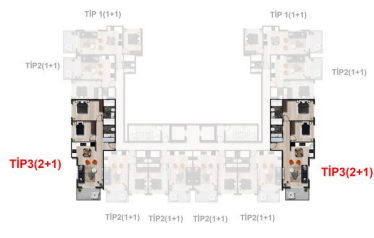

2+1 DAIRE PLANI
BRÜT=83 m2

TIP 3 (2+1) PLANI



Відскануйте QR-код, щоб відкрити початкову сторінку